

Peanut Lake Road
the dirt road West of Butte Ave. is a county road and no leashes are required

Block 79 / Dirt Jump Area
5 acres near the public biking/walking path, adjacent to the BMX bike course

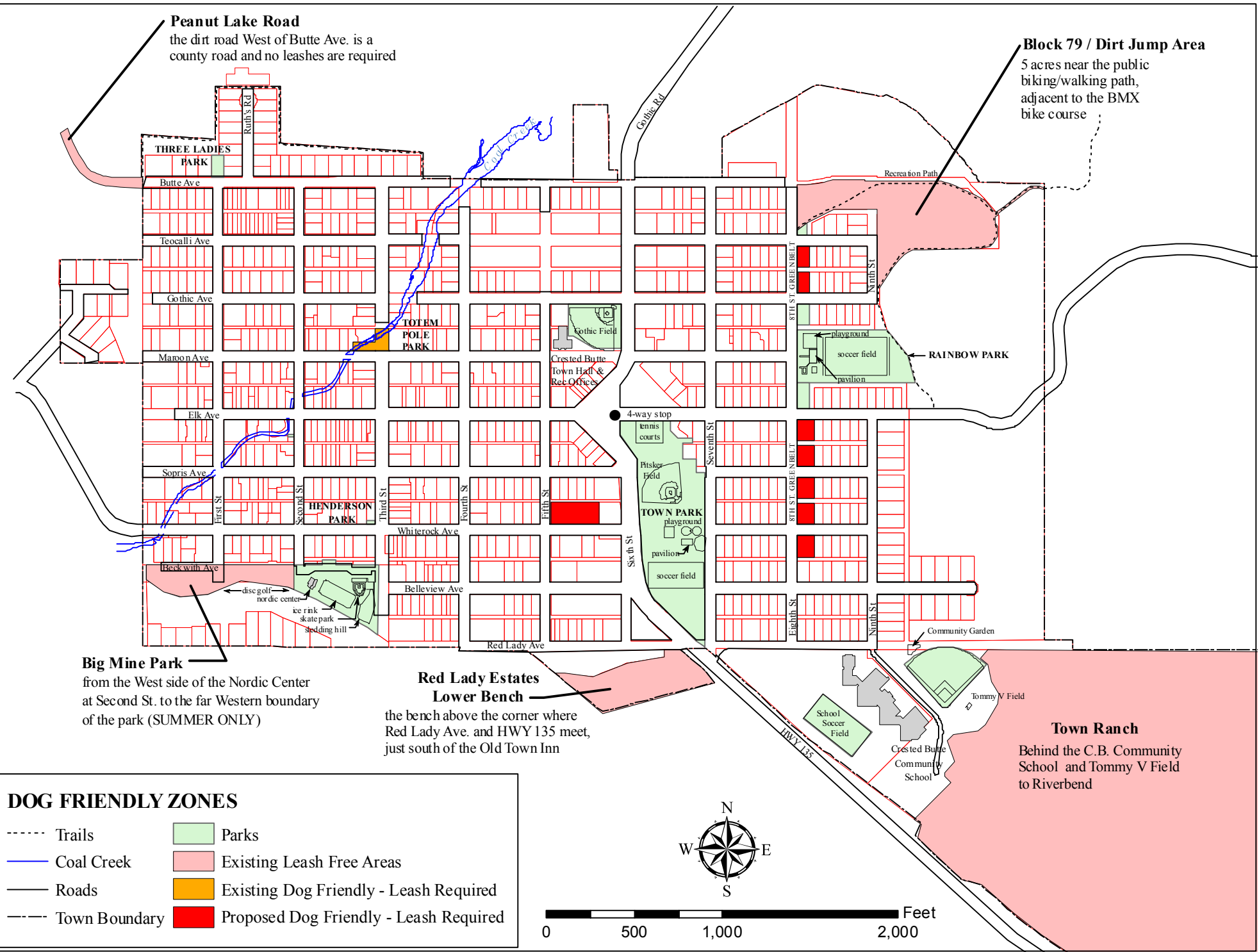

Big Mine Park
from the West side of the Nordic Center at Second St. to the far Western boundary of the park (SUMMER ONLY)

Red Lady Estates Lower Bench
the bench above the corner where Red Lady Ave. and HWY 135 meet, just south of the Old Town Inn

Town Ranch
Behind the C.B. Community School and Tommy V Field to Riverbend

DOG FRIENDLY ZONES

----- Trails	█ Parks
— Coal Creek	█ Existing Leash Free Areas
— Roads	█ Existing Dog Friendly - Leash Required
----- Town Boundary	█ Proposed Dog Friendly - Leash Required

